

| | | |
|---------------|---|----------------------|
| GOTMAR | Technical Data Sheet handle milk | <i>HANDLE_038-05</i> |
| | | <i>Page. 1 of 1</i> |
| | | <i>06.01.2017 z.</i> |
| | | <i>Revision 2</i> |

1. Description:

1.1 Handle milk Ø 38/33, with 22 pins

2. Material:

HDPE

3. Weight:

3.1 Weight of the handle - 2.5 g. ± 5%

4. Dimensions:

See the attached drawing of the article.

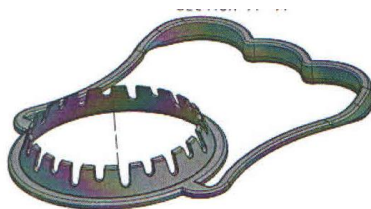

5. Neck:

Twist off 38 mm, one way use.

6. Packaging:

6.1 Cardboard box, produced from 5-layered corrugated cardboard with PE bag inside sealed with scotch tape.

6.1.1 Dimensions of the cardboard box: L - 585mm; I - 384 mm; H - 411 mm.

6.1.2 Quantity of handles per cardboard box - 2500 pcs.

6.2 PE bag

6.2.1 Dimensions of the PE bag: L - 60 mm; I - 105 mm; H - 1 000 mm.

7. Storage:

7.1 Dry place, out of contaminations and direct sunlight.

7.2 Recommended storage temperature: $0^{\circ}\text{C} \div 35^{\circ}\text{C}$ max

7.3 The handles should be thermal equilibrated with the ambient temperature of the workshop at least 48 hours prior the use ($16^{\circ}\text{C} \div 25^{\circ}\text{C}$)